

# TopDrip PC & PC AS



**Pressure-compensating (PC) and anti-syphon (PC AS), thin to medium-walled dripline for maximum irrigation uniformity (EU-95%) at minimum cost**

## APPLICATIONS

- Row crops and vegetables
- Subsurface drip irrigation (SDI)
- Variable topography
- Irrigation of long rows with high uniformity

## STRUCTURE AND FEATURES

- Accurate pressure-compensating dripper
- Low CV: 3.0%
- Cascade labyrinth incorporated for maximal clog resistance
- Protection from root intrusion
- Unique double self-cleaning mechanism
- Allows longer laterals with EU of 95%
- Large water passages for optimal durability at low flow rates
- Multiple channel water inlet for operation under heavy dirt load
- Close dripper spacing creates a continuous wetted strip

## SPECIAL MODEL PC AS :

- Anti-syphon design prevents suction at draining stage
- Recommended for subsurface drip irrigation

**TopDrip PC**



1.0, 1.6 l/h

**TopDrip PC AS**



1.0, 1.6 l/h



Shallow profile reduces head losses and raised water inlet reduces clogging

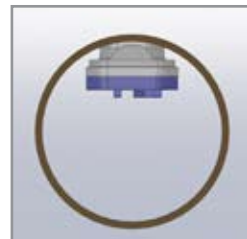

Weir design prevents root intrusion and sand suction

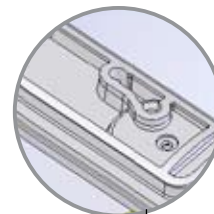

**3 PARTS-UPPER VIEW**

Multi-channel: three-dimensional water inlets and eleven independent entrances

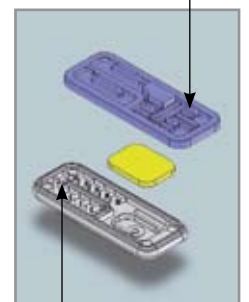
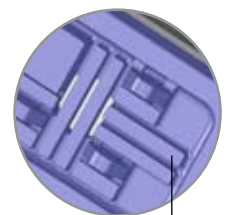

Cascade labyrinth wide water passages and strong self-cleaning operation

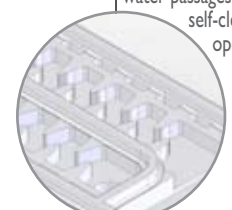

**3 PARTS-BOTTOM VIEW**

# TopDrip PC & PC AS

## TECHNICAL DATA

- Flow rate: 1.0, 1.6 l/h
- Pressure regulating range: 0.4-2.5 bar
- Operating pressure: 0.4-2.5 bar, according to wall thickness
- Wall thickness: 13-25 mil, 0.33-0.63 mm
- Recommended filtration: 130 micron (120 mesh)

## TECHNICAL DATA

Nominal diameter	Wall thickness		ID (mm)	OD (mm)	Max. Pressure (bar)	Connectors
	mil	mm				Tape
16	13	0.33	16.2	16.86	1.4	●
	15	0.38	16.2	16.96	1.8	●
	18	0.45	15.8	16.70	2.0	●
22	25	0.63	15.6	16.86	2.5	●
	13	0.33	22.2	22.86	1.2	●
	15	0.38	22.2	22.96	1.4	●
	18	0.45	22.2	23.10	1.7	●
	25	0.63	22.2	23.46	2.0	●

## TOPDRIP PACKAGING AND SHIPPING

Carton spools						
Nominal diameter (mm)	Wall thickness (mil)	Standard coil* length (m)	Coils per pallet	Coils per 20 ft. container	Coils per 40 ft. container	Coils per 40 ft. HC container
16mm	13	1250	16	320	640	720
16mm	15	1250	16	320	640	720
16mm	18	1150	16	320	640	720
16mm	25	700	16	320	640	720
22mm	13	550	16	320	640	720
22mm	15	500	16	320	640	720
22mm	18	450	16	320	640	720
22mm	25	375	16	320	640	720

\* Dropper spacing can affect coil length.



# TopDrip PC & PC AS

## HEAD LOSS (M) IN RELATION TO LATERAL LENGTH (M), DRIPPER FLOW RATE AND SPACING (CM)

TopDrip 16, 1.0 l/h, W.T13-15 mil, ID 16.2								
Lateral length(m)	Dripper spacing (cm)							
	20	30	40	50	60	70	100	
20	0.1							
40	0.3	0.1	0.1					
60	0.9	0.4	0.2	0.1	0.1	0.1		
80	2.0	0.8	0.4	0.3	0.2	0.1	0.1	
100	3.5	1.5	0.8	0.5	0.3	0.2	0.1	
120	5.8	2.4	1.3	0.8	0.5	0.4	0.2	
140	8.7	3.6	1.9	1.2	0.8	0.6	0.3	
160	12.4	5.1	2.8	1.7	1.2	0.9	0.4	
180		7.0	3.8	2.4	1.6	1.2	0.6	
200		9.3	5.0	3.2	2.2	1.6	0.8	
220		12.1	6.5	4.1	2.8	2.0	1.0	
240			8.3	5.2	3.6	2.6	1.3	
260			10.3	6.4	4.4	3.2	1.6	
280			12.6	7.9	5.4	4.0	1.9	
300				9.5	6.6	4.8	2.3	
320				11.4	7.8	5.7	2.8	
340					9.2	6.7	3.3	
360					10.8	7.9	3.9	
380						9.1	4.5	
400						10.6	5.2	
420							5.9	
440							6.7	
460							7.6	
480							8.6	
500							9.6	

TopDrip 16, 1.0 l/h, W.T 18mil, ID 15.8								
Lateral length(m)	Dripper spacing (cm)							
	20	30	40	50	60	70	100	
20	0.1							
40	0.3	0.1	0.1					
60	1	0.4	0.2	0.1	0.1	0.1		
80	2.1	0.9	0.5	0.3	0.2	0.1	0.1	
100	3.7	1.6	0.8	0.5	0.4	0.3	0.1	
120	6.1	2.5	1.4	0.8	0.6	0.4	0.2	
140	9.2	3.8	2.1	1.3	0.9	0.6	0.3	
160		5.5	3	1.9	1.3	0.9	0.5	
180		7.5	4.1	2.6	1.8	1.3	0.6	
200		10	5.4	3.4	2.4	1.7	0.8	
220			7	4.4	3	2.2	1.1	
240			8.9	5.6	3.9	2.8	1.4	
260			11.1	7	4.8	3.5	1.7	
280				8.6	5.9	4.3	2.1	
300				10.3	7.2	5.2	2.6	
320					8.5	6.3	3.1	
340					10.1	7.4	3.6	
360						8.6	4.2	
380						10.0	4.9	
400							5.7	
420							6.5	
440							7.4	
460							8.4	
480							9.4	
500							10.6	

TopDrip 16, 1.0 l/h, W.T 25mil, ID 15.6								
Lateral length(m)	Dripper spacing (cm)							
	20	30	40	50	60	70	100	
20	0.1							
40	0.3	0.1	0.1					
60	1.0	0.4	0.2	0.1	0.1	0.1		
80	2.2	0.9	0.5	0.3	0.2	0.2	0.1	
100	3.9	1.6	0.9	0.5	0.4	0.3	0.1	
120	6.4	2.7	1.4	0.9	0.6	0.5	0.2	
140	9.6	4.0	2.2	1.4	0.9	0.7	0.3	
160	13.8	5.8	3.1	2	1.4	1.0	0.5	
180	18.9	7.9	4.3	2.7	1.9	1.4	0.7	
200		10.5	5.8	3.6	2.5	1.8	0.9	
220		13.7	7.5	4.7	3.3	2.4	1.2	
240		17.3	9.5	6.0	4.1	3.0	1.5	
260		21.5	11.8	7.4	5.2	3.8	1.9	
280			14.4	9.1	6.3	4.6	2.3	
300			17.4	11.0	7.7	5.6	2.8	
320			20.9	13.2	9.1	6.7	3.3	
340				15.6	10.8	7.9	3.9	
360				18.2	12.6	9.3	4.6	
380				21.1	14.7	10.7	5.3	
400					16.9	12.4	6.1	
420					19.3	14.2	7.0	
440					22.0	16.1	8.0	
460						18.3	9.0	
480						20.5	10.2	
500							11.4	

\* Minimum working pressure 0.4 bar. Maximum working pressure according to wall thickness.



# TopDrip PC & PC AS

## HEAD LOSS (M) IN RELATION TO LATERAL LENGTH (M), DRIPPER FLOW RATE AND SPACING (CM)

TopDrip 16, 1.6 l/h, W.T 13-15mil, ID 16.2							
Lateral length(m)	Dripper spacing (cm)						
	20	30	40	50	60	70	100
20	0.1						
40	0.7	0.3	0.2	0.1	0.1		
60	2.0	0.8	0.4	0.3	0.2	0.1	0.1
80	4.3	1.8	0.9	0.6	0.4	0.3	0.1
100	7.7	3.2	1.7	1.1	0.7	0.5	0.3
120	12.6	5.3	2.8	1.8	1.2	0.9	0.4
140		7.9	4.3	2.7	1.9	1.3	0.7
160		11.4	6.2	3.9	2.7	1.9	1.0
180			8.5	5.3	3.7	2.7	1.3
200			11.3	7.1	4.9	3.6	1.8
220				9.2	6.4	4.7	2.3
240				11.7	8.1	5.9	2.9
260					10.1	7.4	3.6
280						12.3	9.1
300							10.9
320							
340							
360							
380							
400							
420							
440							
460							
480							
500							

TopDrip 16, 1.6 l/h, W.T 18mil, ID 15.8							
Lateral length(m)	Dripper spacing (cm)						
	20	30	40	50	60	70	100
20	0.1						
40	0.7	0.3	0.2	0.1	0.1	0.1	
60	2.1	0.9	0.5	0.3	0.2	0.1	0.1
80	4.5	1.9	1.0	0.6	0.4	0.3	0.2
100	8.2	3.4	1.9	1.2	0.8	0.6	0.3
120	13.4	5.6	3.0	1.9	1.3	1.0	0.5
140		8.5	4.6	2.9	2.0	1.5	0.7
160			12.2	6.7	4.2	2.9	1.0
180				9.2	5.8	4.0	1.4
200				12.2	7.7	5.4	1.9
220					10.0	6.9	2.5
240					12.7	8.9	3.2
260						11.0	8.1
280							9.9
300							12.0
320							
340							
360							
380							
400							
420							
440							
460							
480							
500							

TopDrip 16, 1.6 l/h, W.T 25mil, ID 15.6							
Lateral length(m)	Dripper spacing (cm)						
	20	30	40	50	60	70	100
20	0.1						
40	0.7	0.3	0.2	8	0.1	0.1	
60	2.2	0.9	0.5	0.3	0.2	0.2	0.1
80	4.7	2	1.1	0.7	0.5	0.3	0.2
100	8.6	3.6	2	1.2	0.9	0.6	0.3
120	14	5.9	3.2	2	1.4	1.0	0.5
140	21.2	9	4.9	3.1	2.2	1.6	0.8
160			12.9	7.1	4.5	3.1	1.1
180			17.7	9.8	6.2	4.3	1.6
200			23.7	13.0	8.2	5.7	2.1
220				16.9	10.7	7.4	2.7
240				21.5	13.6	9.5	3.4
260					17	11.8	8.7
280					20.8	14.4	10.7
300						17.5	12.9
320						20.9	15.4
340							18.2
360							21.3
380							
400							
420							
440							
460							
480							
500							

\* Minimum working pressure 0.4 bar. Maximum working pressure according to wall thickness.

TopDrip 22, 1.0l/h, W.T 13-25mil, ID 22.2							
Lateral length(m)	Dripper spacing (cm)						
	20	30	40	50	60	70	100
40	0.1	0.1					
60	0.3	0.1	0.1	0.1			
80	0.6	0.3	0.2	0.1	0.1	0.1	
100	0.9	0.4	0.2	0.2	0.1	0.1	
120	1.4	0.7	0.4	0.2	0.2	0.1	0.1
140	2	0.9	0.5	0.4	0.3	0.2	0.1
160	2.8	1.3	0.7	0.5	0.3	0.3	0.1
180	3.6	1.7	1.0	0.6	0.5	0.3	0.2
200	4.7	2.2	1.3	0.8	0.6	0.4	0.2
220	5.9	2.7	1.6	1.0	0.7	0.6	0.3
240	7.3	3.4	2.0	1.3	0.9	0.7	0.3
260	8.8	4.1	2.4	1.6	1.1	0.8	0.4
280	10.6	4.9	2.9	1.9	1.3	1.0	0.5
300	12.6	5.8	3.4	2.2	1.6	1.2	0.6
320	14.6	6.9	4.0	2.6	1.9	1.4	0.7
340		8.0	4.6	3.0	2.2	1.6	0.8
360		9.2	5.4	3.5	2.5	1.9	1.0
380		10.6	6.2	4.0	2.9	2.1	1.1
400		12.0	7.0	4.6	3.3	2.4	1.3
420		13.6	7.9	5.2	3.7	2.8	1.4
440		15.3	8.9	5.9	4.2	3.1	1.6
460			10.0	6.6	4.7	3.5	1.8
480			11.2	7.3	5.2	3.9	2.0
500			12.4	8.2	5.8	4.3	2.2

TopDrip 22, 1.6l/h, W.T 13-25mil, ID 22.2							
Lateral length(m)	Dripper spacing (cm)						
	20	30	40	50	60	70	100
40	0.2	0.1	0.1				
60	0.5	0.2	0.1	0.1	0.1		
80	1.0	0.5	0.3	0.2	0.1	0.1	
100	1.7	0.8	0.5	0.3	0.2	0.2	0.1
120	2.7	1.2	0.7	0.5	0.3	0.2	0.1
140	3.8	1.8	1.0	0.7	0.5	0.4	0.2
160	5.3	2.5	1.4	0.9	0.7	0.5	0.3
180	7.1	3.3	1.9	1.3	0.9	0.7	0.3
200	9.2	4.3	2.5	1.6	1.2	0.9	0.4
220	11.7	5.5	3.2	2.1	1.5	1.1	0.6
240	14.6	6.8	3.9	2.6	1.9	1.4	0.7
260	17.9	8.3	4.8	3.2	2.3	1.7	0.9
280		10.1	5.8	3.8	2.7	2.1	1.1
300		12.0	7.0	4.6	3.3	2.4	1.3
320		14.2	8.3	5.4	3.9	2.9	1.5
340		16.6	9.7	6.3	4.5	3.4	1.7
360			11.2	7.4	5.2	3.9	2.0
380			12.9	8.5	6.1	4.5	2.3
400			14.8	9.7	6.9	5.2	2.7
420			16.8	11.0	7.9	5.9	3.0
440				12.5	8.9	6.7	3.4
460				14.0	10.0	7.5	3.9
480				15.7	11.2	8.4	4.3
500				17.5	12.5	9.4	4.8

\* Minimum working pressure 0.4 bar. Maximum working pressure according to wall thickness.

